

PIONEER WYS-17 Series Heat Pump Inverter Parts Diagram

System Model: WYS036GMFI17RD
System Code: 22022010003573
Power Supply: 208~230 V, 1 Ph, 60Hz.

Outdoor Unit Model: YN036GMFI17RPD
Outdoor Code: 22022016005120

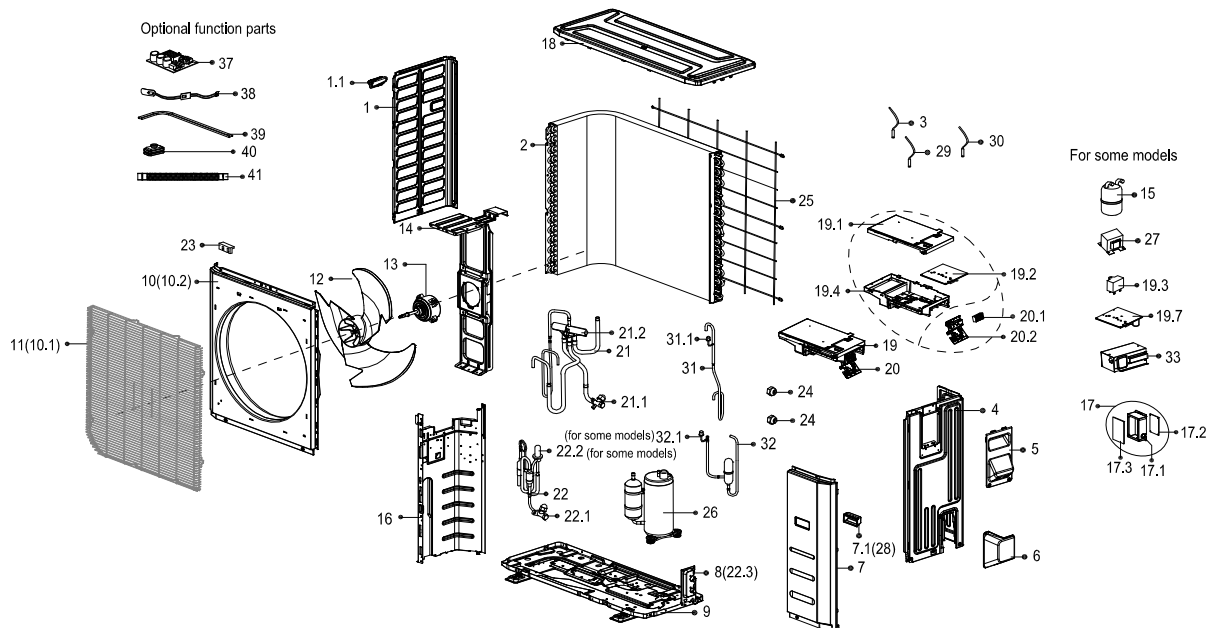

No.	Part Name	Quantity	BOM Code	BIN No.	Remark
1	Left side plate assembly of cabinet	1.0	12222000006665	48	
1.1	Small Handle	1.0	12100701000033	1	
2	Condenser assembly	1.0	15822000003722	1060	
3	Temperature Sensor	1.0	11201007000006	5	
4	Rear right clapboard assembly	1.0	12222000006664	82	
5	Big Handle	1.0	12222000004019	8	
6	Water Collecting Cover	1.0	12122200002695	7	
7	Front right clapboard assembly	1.0	12222500000633	61	
7.1	Little Handle	1.0	12100702000038	2	
9	Chassis assembly	1.0	12222000004762	149	
10	Front panel	1.0	12222000004983	123	
11	Air Outlet Guard	1.0	12222200000907	152	
12	Axial fan	1.0	12100105000084	58	
13	Brushless DC Motor	1.0	11002015000247	297	
14	Holder for fan motor assembly	1.0	12222000005162	65	
15	Accumulator cylinder	1.0	15500508000002	117	
16	Separator Assembly	1.0	12222200001158	36	
18	Top cover assembly	1.0	12222500000541	79	
19	Electronic control box assembly	1.0	17222000009488	1568	
19.1	Electric Installing Box Subassembly	1.0	12122200002719	52	
19.2	Outdoor main control board assembly	1.0	17122000018873	331	
19.4	Electric Installing Box Subassembly	1.0	12122200002715	33	
19.7	Variable-frequency Module Subassembly (Tie-in, RoHS)	1.0	17122000015997	1200	
20	Terminal Block Subassembly of Electrical Control Box	1.0	17222000002906	40	
20.1	Wire holder	1.0	17400401000037	11	
20.2	Wiring terminal installing plate	1.0	12222200001476	4	
21		1.0	15422000004953	190	
21.1	Low Pressure Valve	1.0	15500204000025	44	
21.2	4-way Valve	1.0	15500216000003	96	
22	Liquid valve assembly	1.0	15422000004954	326	
22.1	Low Pressure Valve	1.0	15500204000021	29	
22.2	Electronic expansion valve	1.0	15500213000245	274	
22.3	Installation plate for valves	1.0	12222200002110	6	
23	Clamp of front net	8.0	12122000006844	0	
24	Brass Nut	1.0	15500406000010	4	
24	Brass Nut	1.0	15500406000003	8	
25	Rear net	1.0	12222000006604	29	
26	DC+Inverter+Rotary+Compressor	1.0	11103020000319	1102	
29	Discharge temperature sensor assembly	1.0	11201007000157	7	
30	Room Temperature Sensor	1.0	11201007000039	4	
31	Low Pressure Valve assembly	1.0	15122000009629	79	
31.1	Pressure controller	1.0	17400516000024	24	
32	Parts of compressor exhaust pipe	1.0	15122000011324	72	
32.1	Pressure controller	1.0	17400516000007	27	