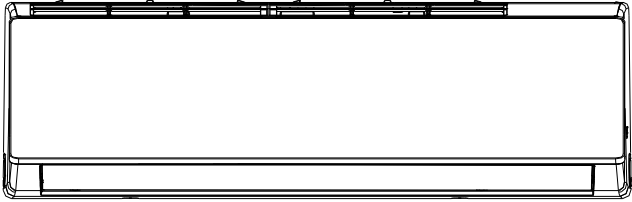
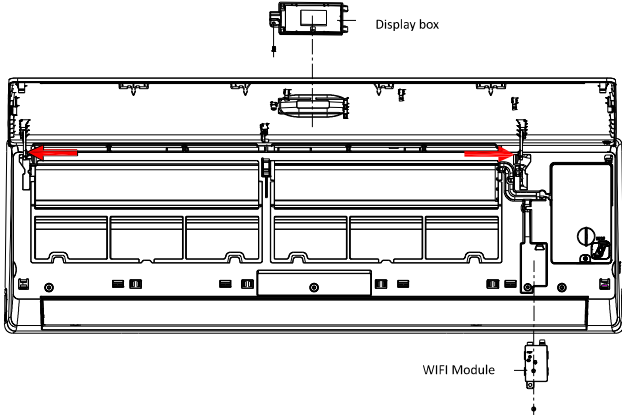
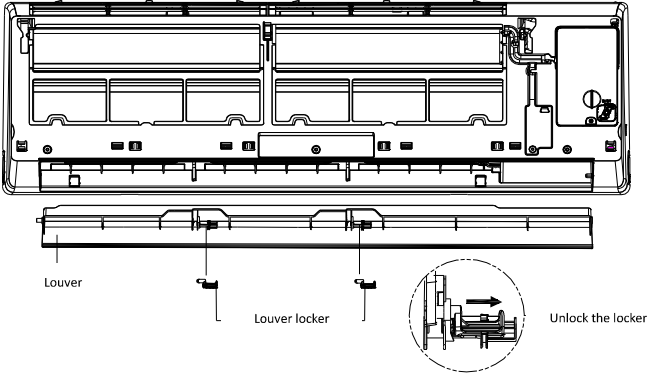

4. Disassembly IDU & ODU

4.1. IDU Disassembly

Steps	Reference photo
1. Before disassembly	
<p>The original status.</p>	
2. Disassembly front panel, display board and WIFI module.	
<p>A. Open front panel. B. Remove one screw and take the display box out from the panel. C. Release panel axis which shown in red arrows out from middle frame and take the panel out. D. Unscrew and take the WIFI module out from middle frame.</p>	
3. Remove the louver.	
<p>Unlock the louver lockers (clip), bend the louver slightly by hands and remove it out from middle frame and stepping motor.</p>	

4. Remove the electric control box cover

Unfix one screw on the cover of electric box, and remove the cover.

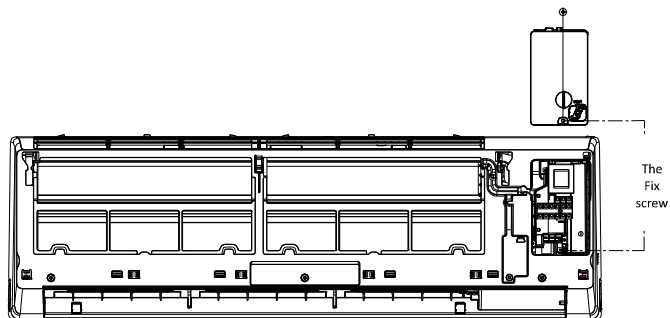

5. Remove the filter

Push the filter upwards a little, you can take it out from unit.

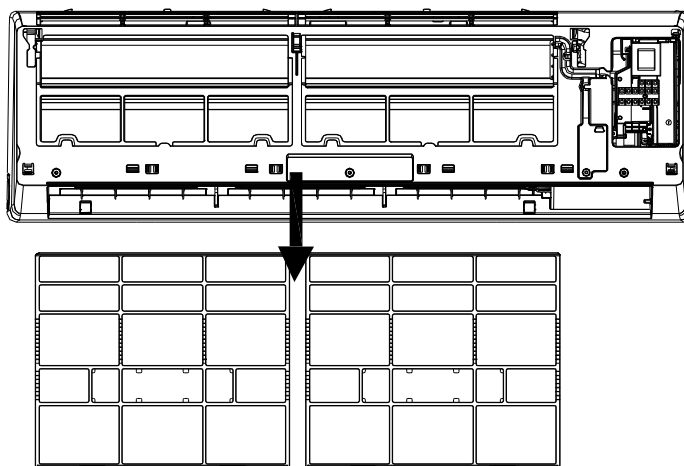

6. Disassembly the middle frame.

- A. Open the screw cover, and unfix screw with cross screwdriver.
- B. Remove the middle frame by loosening the clasps with the unit base as shown in the picture and take the frame out.

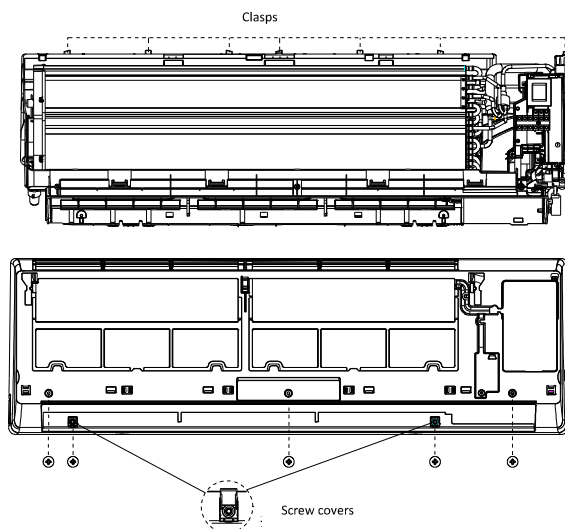

7. Disassembly the electric control box.

- A. Remove the RT & IPT out from evaporator;
- B. Unscrew all the earth ground wirings on the evaporator.
- C. Take all the connectors out from PCB.
- D. Unfix one screw of the control box with unit BASE FRAME, and take the control box out from unit.

Note: The right picture for your reference only, for the exact model the wiring connection may have a little difference.

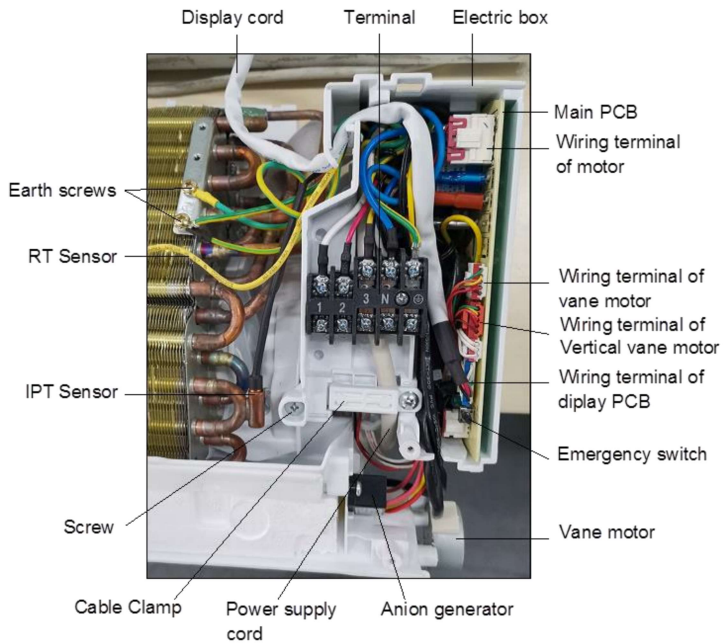
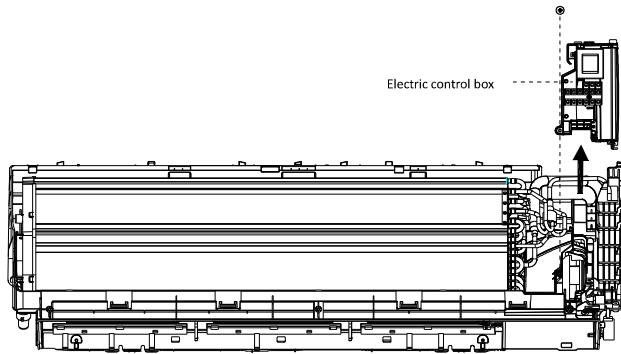

8. Remove the PIPE COVER

Loosing the lower edge of the PIPE COVER from BASE FRAME, and take the COVER out from unit.

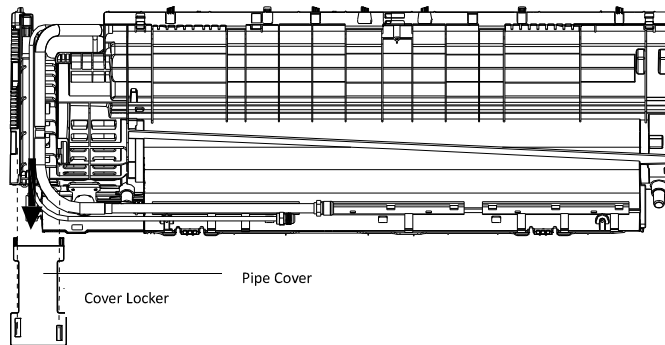

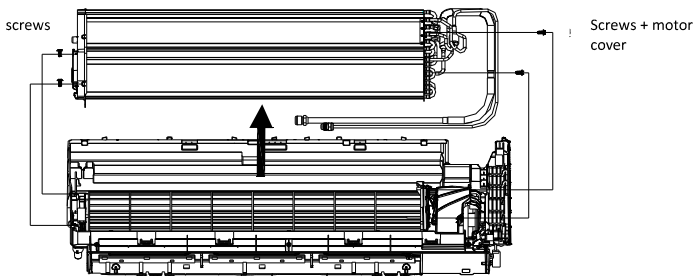
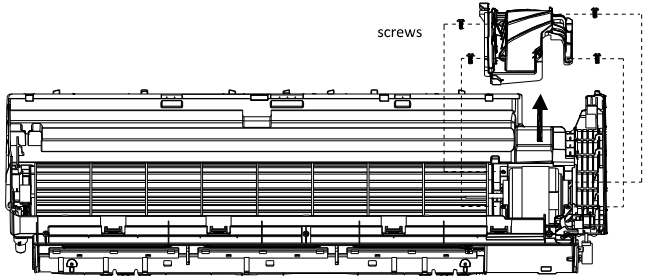
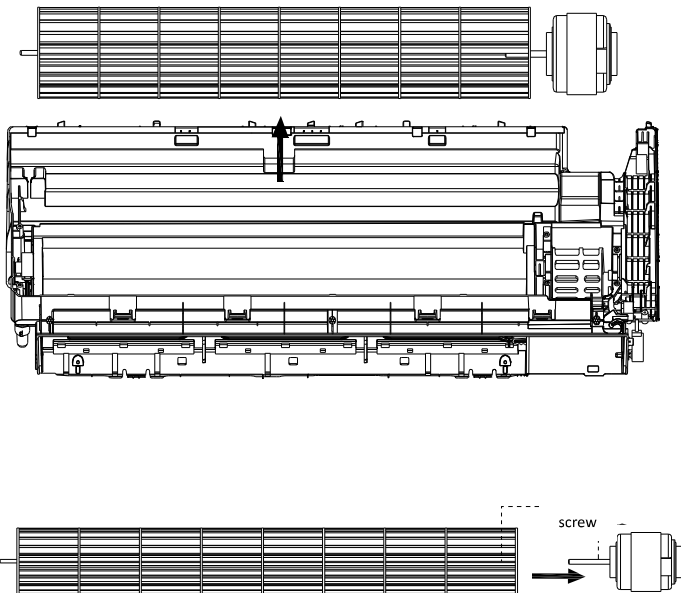
<p>9. Disassembly the evaporator</p> <p>A. Unfix 2 screws of left side shown as picture. B. Unfix 2 screws of right side on motor cover/right support plate. C. Take the evaporator out from unit by uplifting the IUPUT/OUTPUT pipes slightly.</p>	
<p>10. Remove the MOTOR COVER</p> <p>Unfix 4 screws on the motor cover with base frame.</p>	
<p>11. Disassembly fan motor and fan blade.</p> <p>A. Uplift the fan blade and fan motor, take the base frame out. B. Unfix one screw on the axis of fan motor, and you can get fan blade and fan motor separately.</p>	

4.2 ODU Assembly

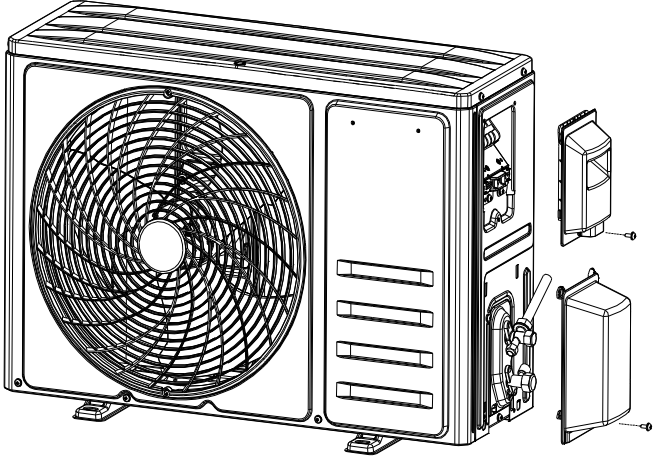
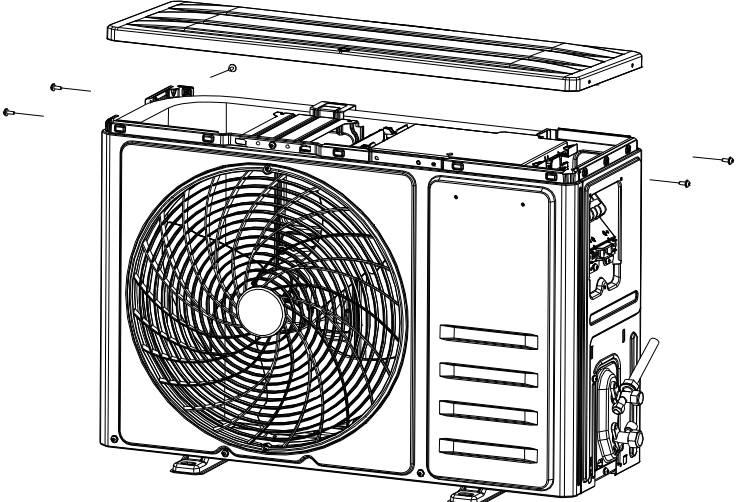
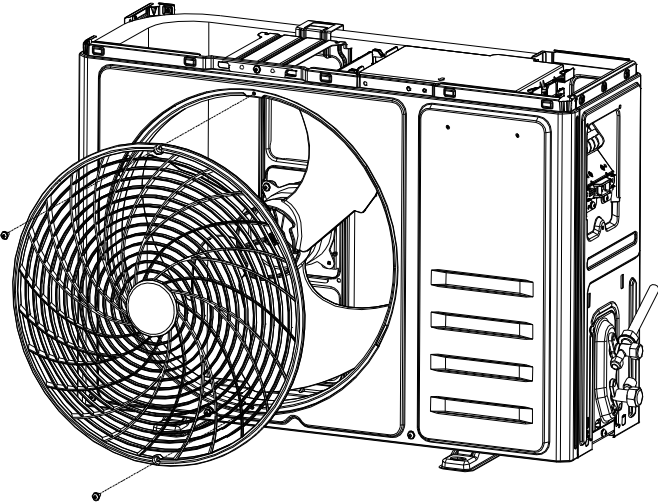
Step	Reference picture
step1: Remove the PCB Cover , valve Cover and top cover	
<p>A</p> <p>1). Unfix one screw on the PCB cover, you can take the cover out from unit.</p> <p>2). Unfix one screw on the valve cover, you can take it out easily.</p>	 <p>The diagram shows the ODU unit with the PCB cover and valve cover removed. The PCB cover is shown as a small rectangular piece with a screw. The valve cover is shown as a larger rectangular piece with a screw. The ODU unit is shown with the fan guard and front panel still attached.</p>
<p>B</p> <p>Unfix screws btw the top cover with front panel, left and right plate, then you can take the top cover out.</p>	 <p>The diagram shows the ODU unit with the top cover removed. The top cover is shown as a long, narrow rectangular piece. The ODU unit is shown with the fan guard and front panel still attached.</p>
step2: Disassemble the Fan Guard and Front Panel	
<p>A</p> <p>Unfix screws on front panel with fan guard.</p>	 <p>The diagram shows the ODU unit with the fan guard and front panel removed. The fan guard is shown as a circular piece with a fan inside. The front panel is shown as a rectangular piece with a screw. The ODU unit is shown with the top cover and PCB cover still attached.</p>

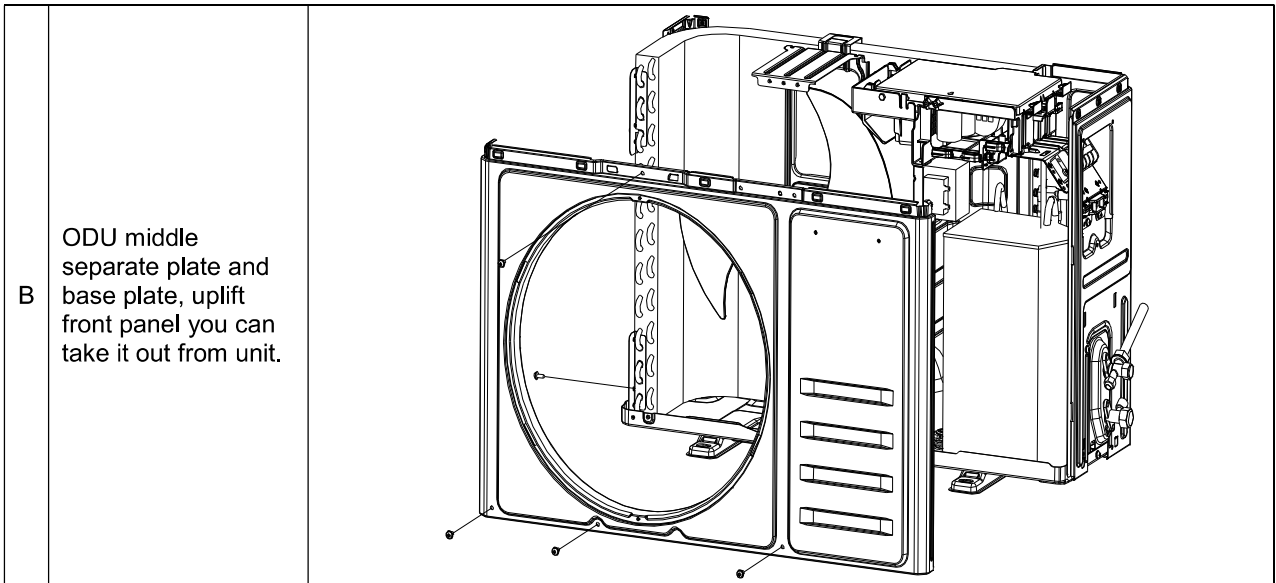

step3: Disassemble the Left and Right plate.

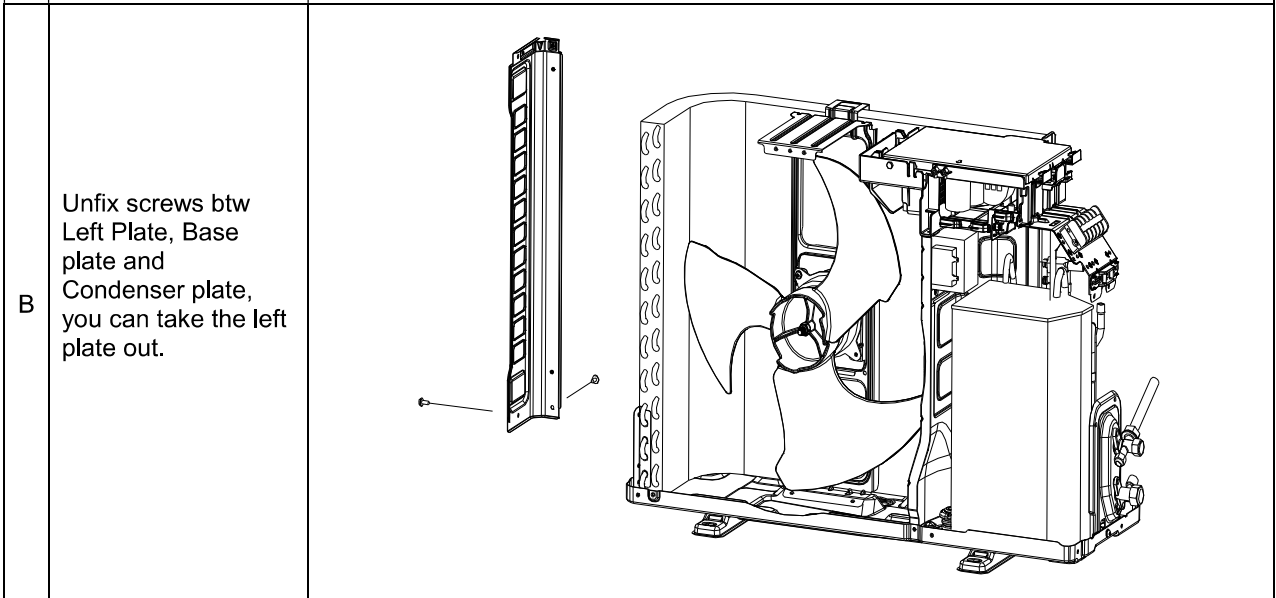
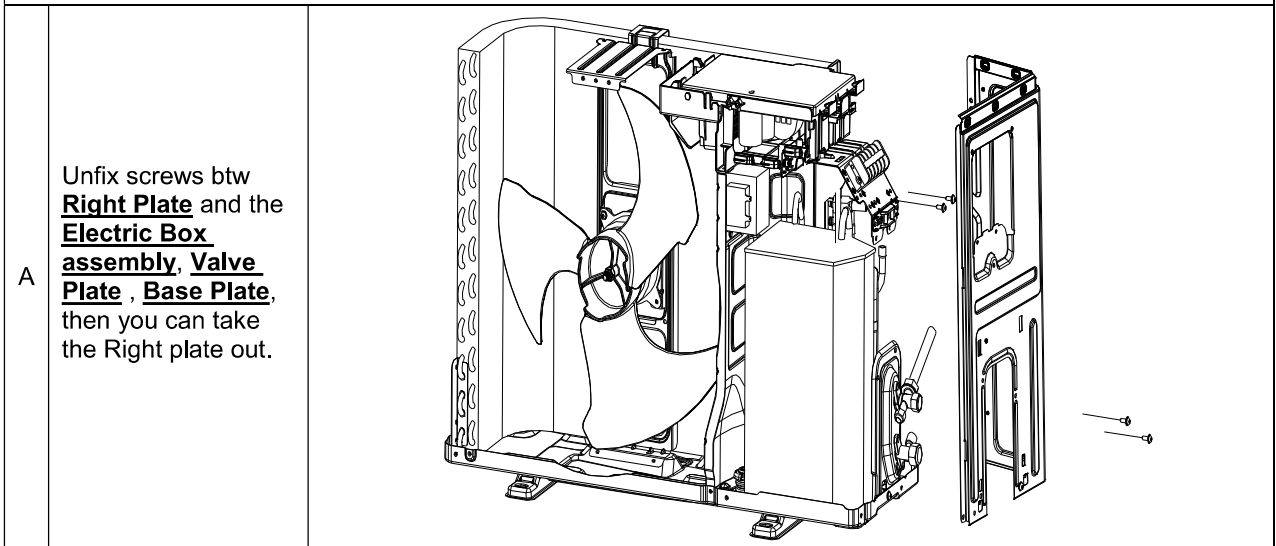

step4: Disassemble the Axis Fan Blade

A Unscrew the fan blade nut, and take the blade out.

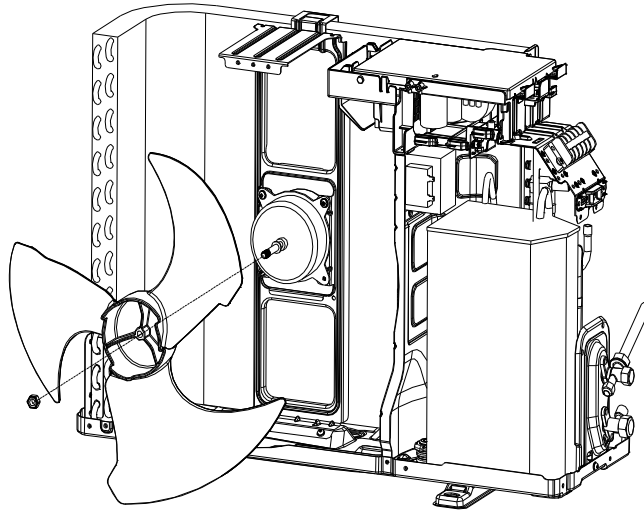

step5: Disassemble the electric box

Unfix screw btw Electric Box and motor supporter etc. loosen the wiring clamp, then you can take the control box out.

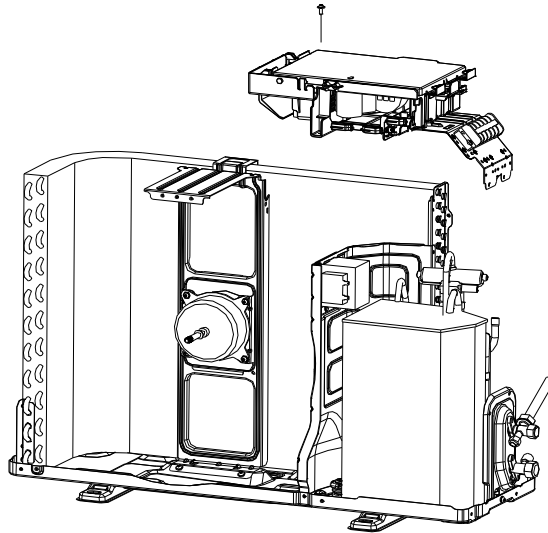

step6: take out the noise cotton

A Shown as picture to take the cotton out

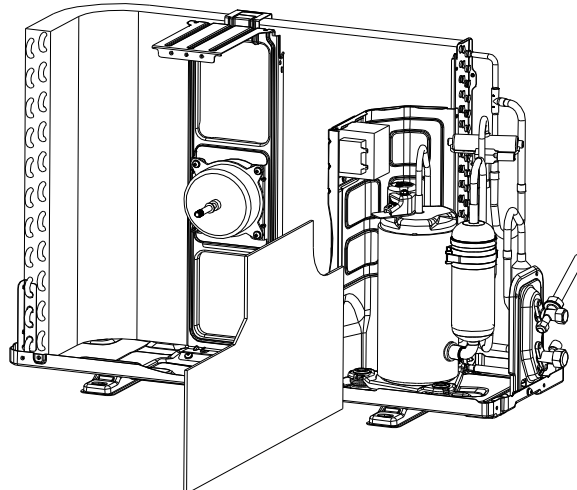

step7: Disassemble the separate plate

Unfix the screw btw separate plate and unit, and take it out

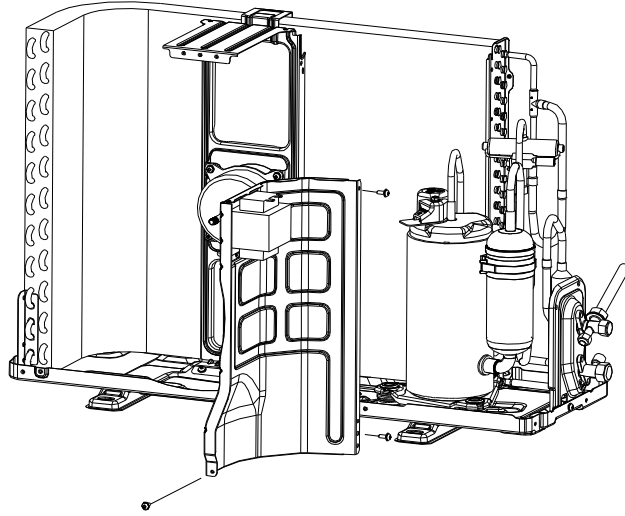

step8: Disassemble the 2 and 3-way valve

Unfix screw btw Valve plate and base, you can take the 2-way and 3-way valve out by welding.

Note:
 1). The welding can only place while no gas in the unit.
 2). Pay attention to the fire to prevent any injury.

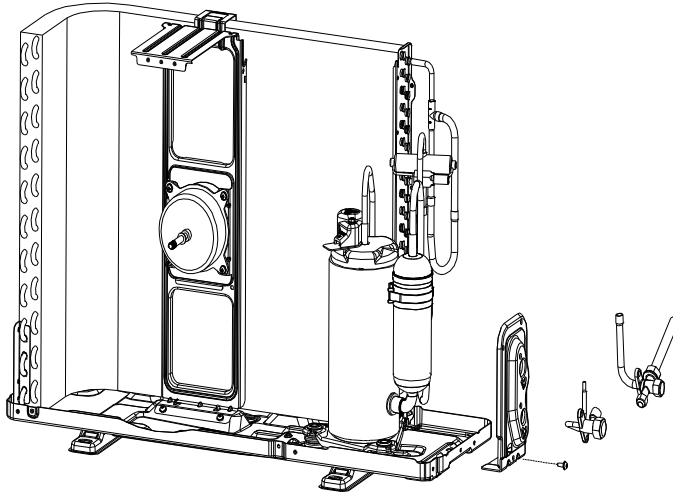

step9: Disassemble the 4-way valve assembly

Take the 4-way valve out from system by welding. Make sure no hurt to the compressor and nameplate, etc.

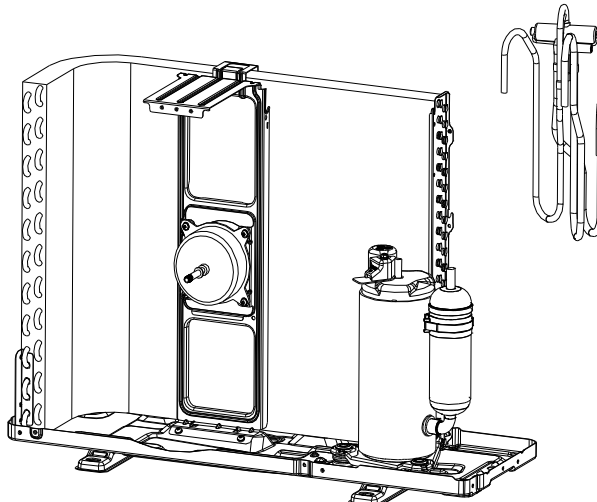

step10: Disassemble the compressor.

Unscrew the nuts
and take the
compressor out.

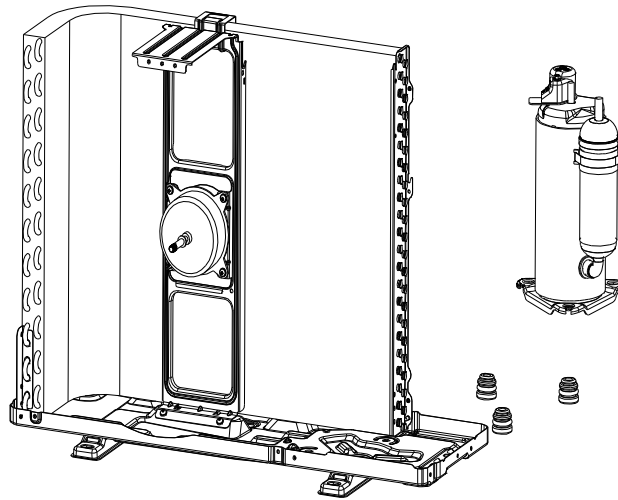

step11: Remove the fan motor and fan supporter.

Unfix screws btw fan
motor with
supporter, and
supporter with base
plate.

Note:
Pay attention to the
motor wiring, it can't
be taken out by
force.

